

# CARLYLE

# CALLAN

## DIMENSIONS

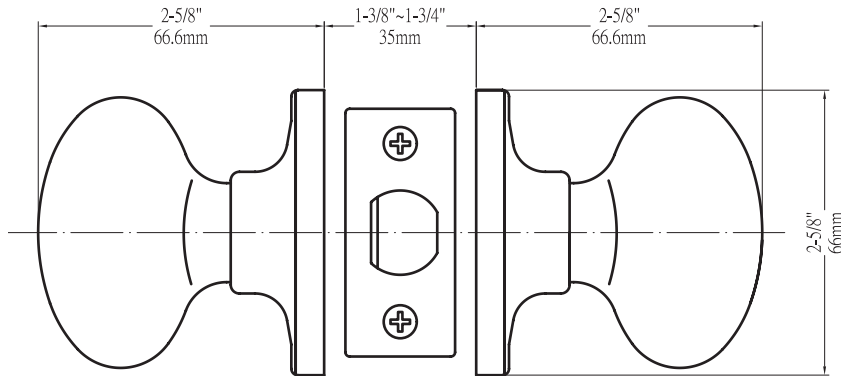

## STANDARD SPECIFICATIONS

<b>Door Prep</b>	Cross bore: 2-1/8" Edge bore: 1" Latch face: 1" x 2-1/4"	<b>Latches</b>	Entrance: 2-3/8" & 2-3/4" adjustable (9073) Passage/Privacy: 2-3/8" & 2-3/4" adjustable (9074) Faceplate: 1" x 2-1/4" round corner Bolt: 1/2" throw
<b>Backset</b>	Fits 2-3/8" and 2-3/4"	<b>Strikes</b>	1-3/4" x 2-1/4" full lip round corner (9103)
<b>Door Thickness</b>	1-3/8" ~ 1-3/4" door standard 2-1/4" Ext. Kit available	<b>Wood Screws</b>	Combination screws that suit both wood or metal door mounting
<b>Cylinder</b>	KW1 5-pin <b>standard</b> ; SC1 5-pin optional Entries packed KA5	<b>Door Handing</b>	Not Required

Model	Function	WT/ LB	CTN QTY		US3 Bright Brass	US15 Satin Nickel	US15A Antique Nickel	US10B Oil Rubbed Bronze	US10BE Edged Bronze	BLACK	Antique Silver
100T - CA	Entrance	27 Lbs	20 Pcs	Item No.	KE1003	KE1001	KE1008	KE1000	KE1007	KE1004	KE1002
101T - CA	Passage	22 Lbs	20 Pcs	Item No.	KE1013	KE1011	KE1018	KE1010	KE1017	KE1014	KE1012
102T - CA	Privacy	22 Lbs	20 Pcs	Item No.	KE1023	KE1021	KE1028	KE1020	KE1027	KE1024	KE1022
115 - CA	Dummy	9 Lbs	20 Pcs	Item No.	KE1053	KE1051	KE1058	KE1050	KE1057	KE1054	KE1052

## FUNCTIONS

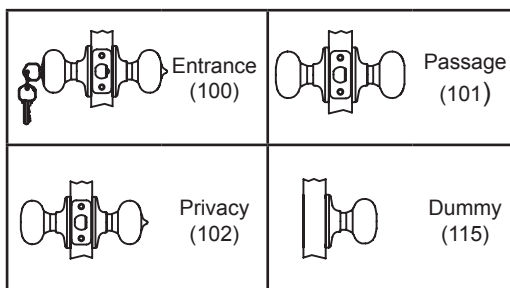

Extension Kits Available



**DELANEY**

Copyright © DELANEY HARDWARE. All rights reserved.